

Workshop manual

T 4000 GP

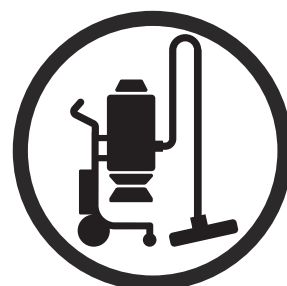

English

Contents

1 Introduction

1.1 Document description.....	3
1.2 Target group.....	3
1.3 Revisions.....	3
1.4 Safety.....	3
1.5 Servicing tools.....	3

2 Safety

2.1 Safety definitions.....	4
2.2 General safety instructions.....	4
2.3 Special safety instructions.....	4
2.4 Symbols on the product.....	4

3 Prepare and do servicing on the product

3.1 Maintenance schedule.....	6
3.2 To clean the product.....	6

4 Function overview

4.1 Type plate/Product serial number.....	7
4.2 Type plate overview.....	7

5 Repair and servicing

5.1 Product overview for repair instructions.....	8
5.2 To clean and examine the product parts.....	8
5.3 To remove and install the generator.....	9
5.4 Top cover.....	9
5.5 Prefilter and HEPA filter.....	10
5.6 Container.....	11
5.7 Fans.....	13
5.8 Electrical system.....	14

6 Transportation

6.1 Transportation of the product.....	16
--	----

7 Troubleshooting

7.1 Troubleshooting.....	17
--------------------------	----

8 Diagrams

8.1 Electrical diagram.....	18
8.2 Electrical diagram.....	19

9 Technical data

9.1 Technical data.....	21
-------------------------	----

1 Introduction

1.1 Document description

This manual gives a full description of how to do maintenance and repair on the product. It also gives safety instructions that the personnel must obey.

1.2 Target group

This manual is for personnel with a general knowledge of how to do repair and do servicing. All personnel that do repair or do servicing on the product must read and understand the manual.

1.3 Revisions

Changes to the product can cause changes to the maintenance work and spare parts. Separate information is sent out for each change.

Read the manual together with all received information about changes to maintenance and spare parts for the product.

1.4 Safety



WARNING: All personnel that repair or do servicing on the product must read and understand the safety instructions in this workshop manual.

1.5 Servicing tools

The manual gives information about necessary servicing tools. Always use original tools from Husqvarna.

2 Safety

2.1 Safety definitions

Warnings, cautions and notes are used to point out specially important parts of the manual.



WARNING: Used if there is a risk of injury or death for the operator or bystanders if the instructions in the manual are not obeyed.



CAUTION: Used if there is a risk of damage to the product, other materials or the adjacent area if the instructions in the manual are not obeyed.

Note: Used to give more information that is necessary in a given situation.



Read the operator's manual carefully and make sure that you understand the instructions before you use this product.



Always use hearing protection, eye protection and respiratory protection.



Gasoline is very flammable and explosive. Always stop the engine and let it become cool before you re-fuel.



The exhaust fumes from the engine contain carbon monoxide, an odorless, poisonous and very dangerous gas. Do not start the engine indoors or in closed spaces

2.2 General safety instructions

- You must obey the safety instructions.
- You must prevent situations that can cause damage or injury.
- You must read the workshop manual before you do work on the product.
- You must read the operator's manual if you operate the product.
- Do not use a damaged product.
- Do not do work on the product if you have health problems that can cause dangerous situations.
- Do not use the product if you are tired, ill, or under the influence of alcohol, drugs or medicine.
- Do not touch the product if your hands are wet.
- Make sure that only approved persons can come near the product.
- Replace all damaged or missing warning symbol decals.



Hot surface.



Risk of fire or explosion.



Risk of carbon monoxide poisoning. Do not operate the product in areas with bad airflow.



Risk of electrical shock.



Risk of burn injury.



Add oil.



Add fuel.



Open the fuel valve.



Set the power switch to the ON position.



Set the choke to the OFF position.

2.3 Special safety instructions



WARNING: Stop the engine before servicing unless the instructions in this manual tell you differently.



WARNING: Let an approved electrician do all checks on the electric components.

2.4 Symbols on the product



WARNING! This product can be dangerous and cause serious injury or death to the operator or others. Be careful and use the product correctly.



Set the choke to the ON position.



Pull the starter rope handle.



Connect the electrical loads.



Disconnect the electrical loads.



Close the fuel valve.



Do not use the tie-down points to lift the product, they are not balanced for lifting.



Securing point on the product.

Note: Other symbols/decals on the product refer to special certification requirements for some markets.

3 Prepare and do servicing on the product

3.1 Maintenance schedule

Note: For servicing instructions for the engine, refer to engine manual.

Operation	Before each use	Daily	At 8 h	At 50 h	Weekly	When suction is low	6 months or 1000 h	12 months or 2000 h
Look for signs of wear, damage or loose connections of the controls.	X							
Do a check of the Longopac dust bag.		X						
Do a check of the guards and covers.		X						
Do a check of the filter cleaning unit.		X						
Do a check for loose or missing clamps.		X						
Examine the dust extractor hose and the connections.		X						
Do a check of the manometer function.		X						
Clean the product.		X						
Replace the HEPA filter.						X		X
Replace the prefilter						X	X	
Do a check of the wheels. Look for damage and make sure that the wheels are correctly attached.					X			
Do a check according to the generator instructions.		X						

3.2 To clean the product



WARNING: Clean the product daily to prevent circulation of dangerous dust.

- Clean the product in an applicable area.
- Use approved protective gloves when you clean the product.
- Clean the external surface with a moist cloth.
- Do not use water on electrical components.
- Do not use a high-pressure washer or compressed air to clean the product.

4 Function overview

4.1 Type plate/Product serial number

The product serial number is given on the type plate.
Supply the model name and the article number when
you send an order for spare parts.

4.2 Type plate overview

The diagram shows a rectangular type plate with the Husqvarna logo at the top left. Below the logo, there are five numbered fields for identification:

- 1. Product # : []
- 2. Model : []
- 3. Serial : []
- 4. []
- 5. []

1. Product number
2. Model
3. Serial number
4. Production date
5. Manufacturer

5 Repair and servicing

5.1 Product overview for repair instructions

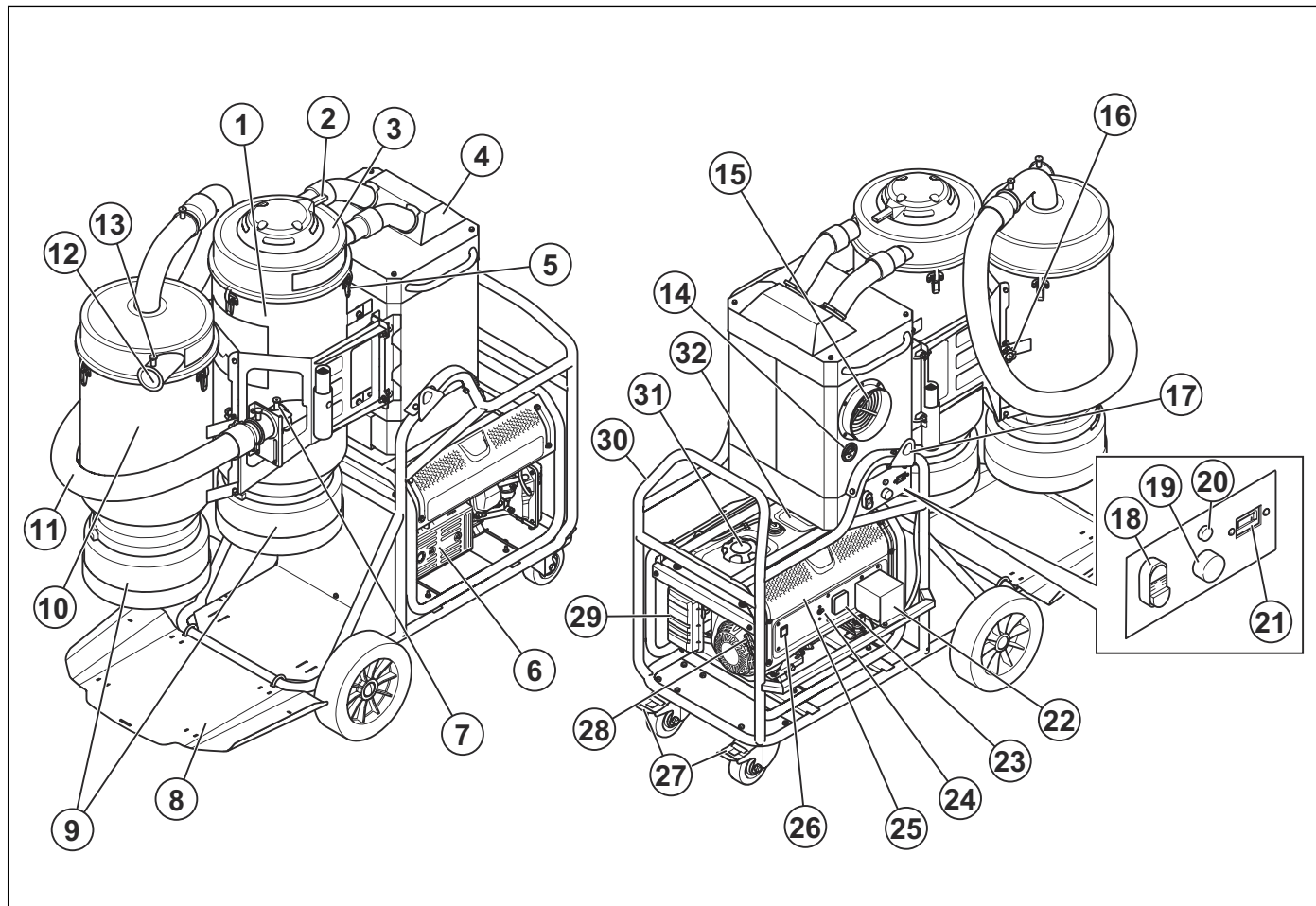

1. Container
2. Jet Pulse cleaning kit
3. Prefilter cover
4. HEPA filter
5. Snap lock
6. Muffler
7. Inlet valve
8. Longopac plate
9. Longopac holder
10. Pre-separator (accessory)
11. Vacuum hose
12. Inlet
13. Hose lock
14. Manometer
15. Air outlet
16. Knob
17. Eyelet
18. ON/OFF switch for the fans
19. Indicator lamp for power
20. Fuse
21. Hour meter
22. Power cord guard
23. VTF meter
24. Circuit breaker
25. Generator engine

26. ON/OFF switch for the generator
27. Caster wheels
28. Starter handle
29. Generator air filter
30. Frame
31. Fuel tank cap
32. Fuel gauge

5.2 To clean and examine the product parts

- Clean and examine all parts fully. You find more instructions in the chapter for each part if special tools or procedures are necessary.
- Replace damaged parts.
- Always use original spare parts.

5.3 To remove and install the generator

1. Remove the 2 screws and the power cord guard from the frame.

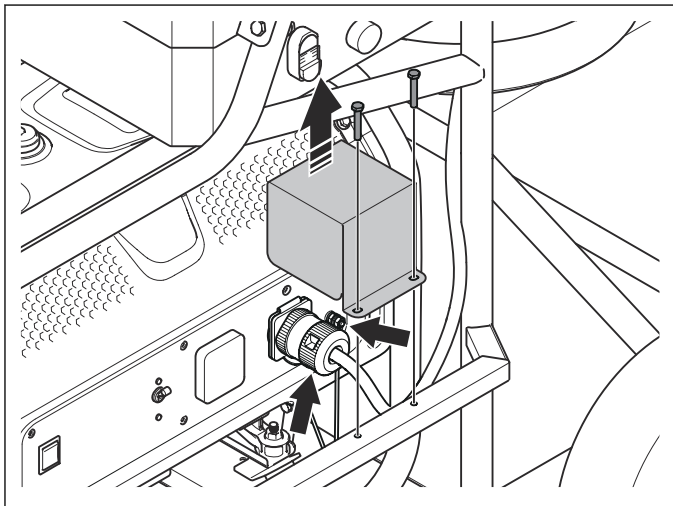

2. Disconnect the power cord and the ground cable from the generator.
3. Remove the 4 nuts that hold the generator to the frame.

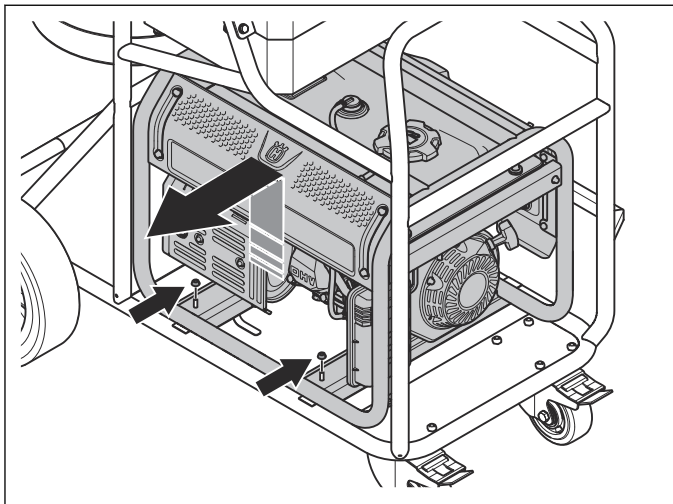

4. Carefully lift the generator and remove it from the frame.
5. Install in the opposite sequence.

5.4 Top cover

5.4.1 To remove and install the top cover

1. Disconnect the 2 hoses from the top cover.

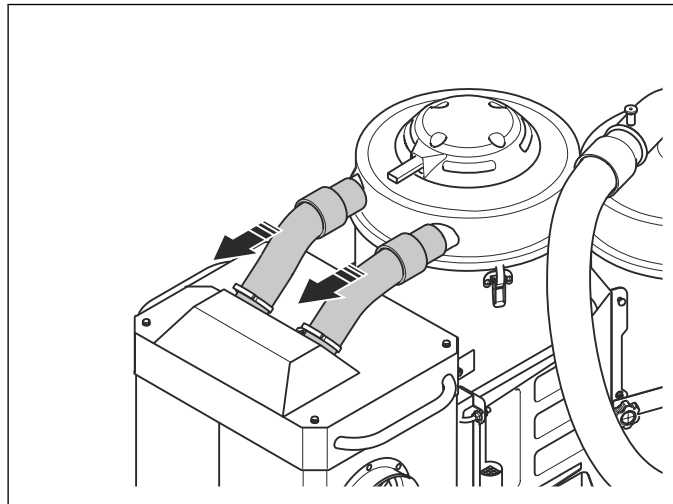

2. Unlock the 3 clamps and remove the top cover.

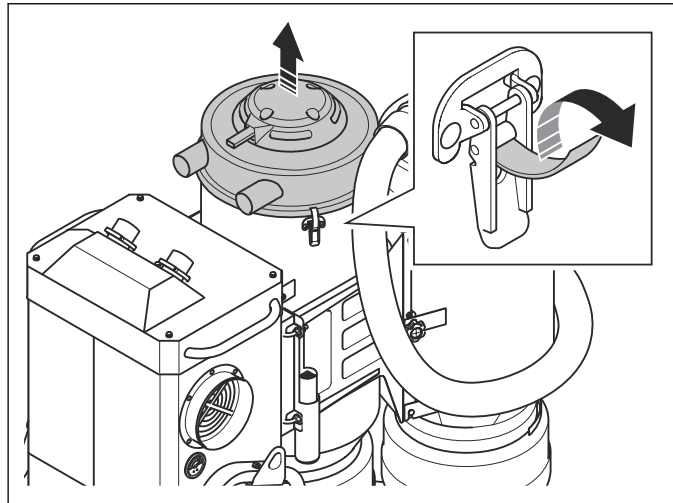

3. Install in the opposite sequence.

5.4.2 To remove the jet pulse cleaning kit

1. Remove the 3 rivets on the top cover to get access to the jet pulse cleaning kit.

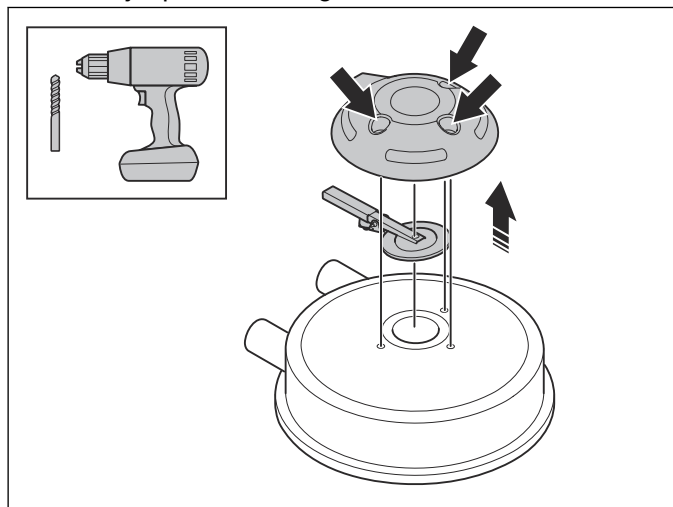

2. Remove the rivet and the jet pulse cleaning kit.

5.4.3 To clean and examine the top cover and the jet pulse cleaning kit

1. Examine the top cover for cracks.
2. Make sure that the jet pulse cleaning kit operates correctly.
3. Remove dust from the top cover with a moist cloth.
4. Replace decals that are damaged.

5.4.4 To install the jet pulse cleaning kit

- Install the jet pulse cleaning kit in the opposite sequence to *To remove the jet pulse cleaning kit on page 9*.

5.5 Prefilter and HEPA filter

5.5.1 To clean the prefilter



CAUTION: Do not hit or drag items across the prefilter surface. The prefilter can become damaged.



CAUTION: Do not use water to clean the prefilter.

- Clean the prefilter in an applicable area.
- Clean the prefilter before you replace the dust bag, or when the operation is completed.
- Clean the prefilter when the manometer on the product is red and shows unsatisfactory suction.
- To clean the prefilter with an external dust extractor, do these steps:
 - a) Remove the top cover. Refer to *To remove and install the top cover on page 9*.
 - b) Lift out the prefilter.
 - c) Clean the outer surface of the prefilter. Install a soft brush on the external dust extractor to prevent damage to the prefilter.
- To clean the prefilter with the jet pulse cleaning kit, do these steps:
 - a) Start the product.
 - b) Close the inlet valve to seal the inlet.
 - c) Wait for 5 seconds for the product to increase the pressure.
 - d) Push and hold the arm to the jet pulse cleaning kit for 5 seconds.
 - e) Wait for 5 seconds again, and then push and hold the arm to the jet pulse cleaning kit for 5 seconds. Do this step again and again until you have pushed the jet pulse cleaning kit 5 times.
- Replace the prefilter if the suction does not become better when you clean the prefilter. Refer to *To replace the prefilter on page 10*.

5.5.2 To replace the prefilter

Only use Husqvarna prefilter.



WARNING: Use approved protective gloves when you replace the prefilter.

1. Remove the top cover. Refer to *To remove and install the top cover on page 9*.
2. Carefully lift the prefilter into a clean plastic bag.

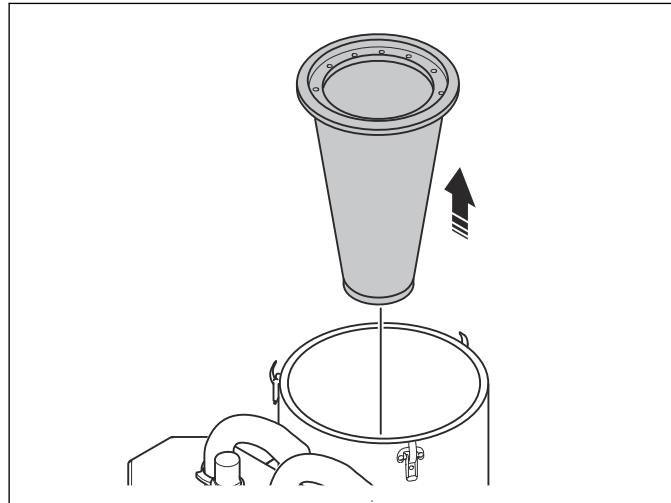

3. Dispose the plastic bag correctly. Refer to local regulations.
4. Install a new prefilter in the tank unit.
5. Install the top cover. Refer to *To remove and install the top cover on page 9*.

5.5.3 To replace the HEPA filters

Only use Husqvarna HEPA filters.



WARNING: Use approved protective gloves when you replace the HEPA filters.



WARNING: Make sure that there are no holes in the HEPA filters. Holes in the HEPA filters can cause a health risk.



CAUTION: Do not clean the HEPA filters. This causes damage to the HEPA filters.



CAUTION: Do not touch the inner surface of the HEPA filters. This causes damage to the HEPA filters.

1. Remove the 5 screws and the 5 washers from the HEPA filter cover.

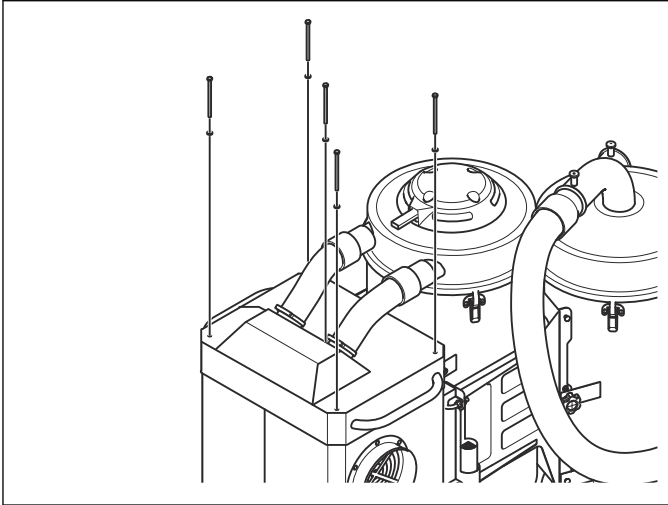

2. Loosen the 2 clamp rings and remove the 2 hoses from the HEPA filter cover.

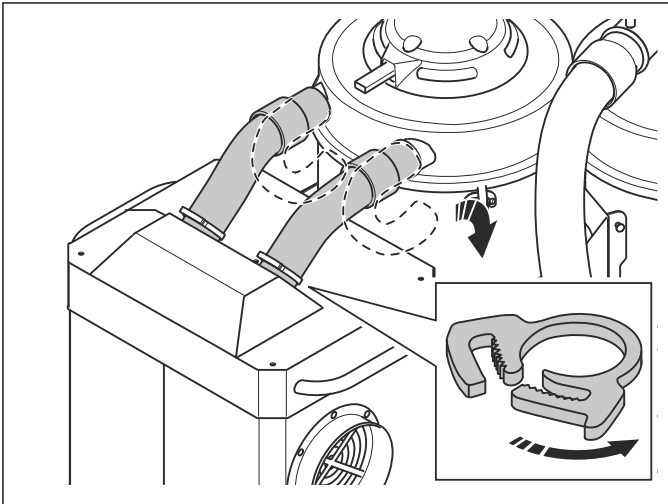

3. Remove the HEPA filter cover and the 3 seals.

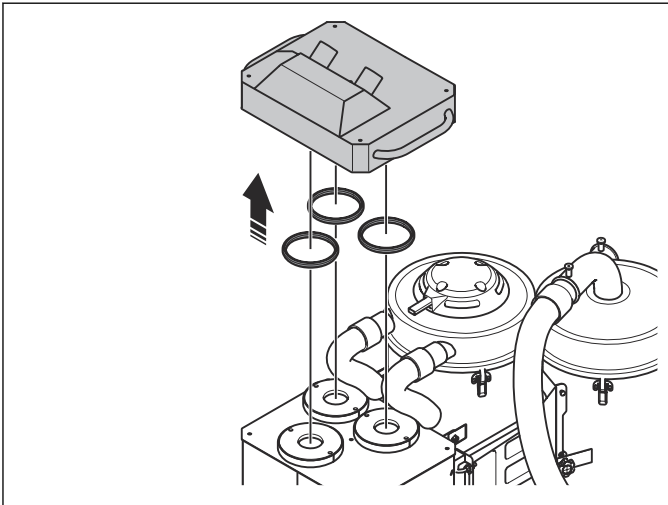

4. Carefully lift the 3 HEPA filters into a clean plastic bag.

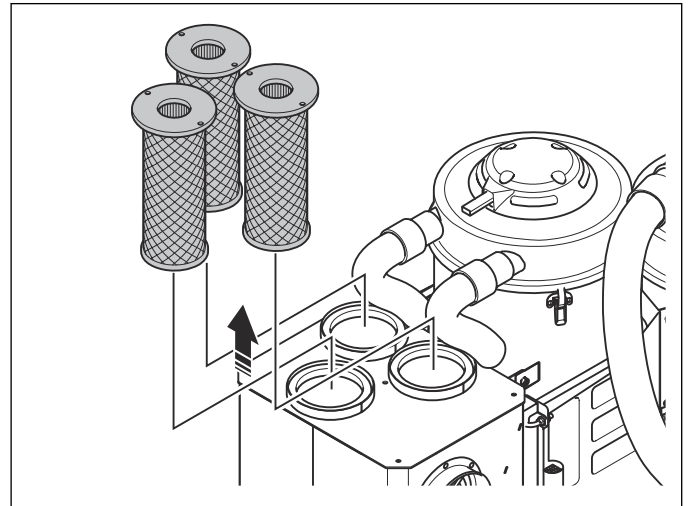

5. Dispose the plastic bag correctly. Refer to local regulations.
6. Install new HEPA filters.
7. Install the HEPA filter cover and the 3 seals.

5.6 Container

5.6.1 To remove and install the pre-separator tank (accessory)

1. Remove the Longopac if it is installed.
2. Disconnect the hose from the primary tank.

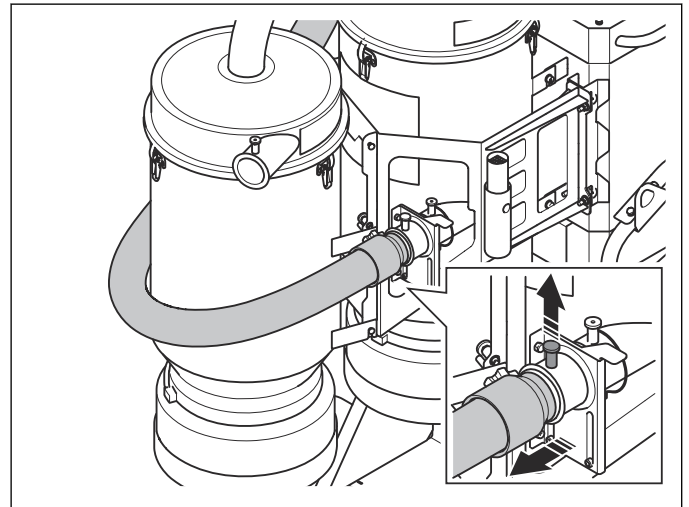

3. Loosen the 2 knobs on the frame for the pre-separator tank. There is 1 knob on the left side and 1 knob on the right side.

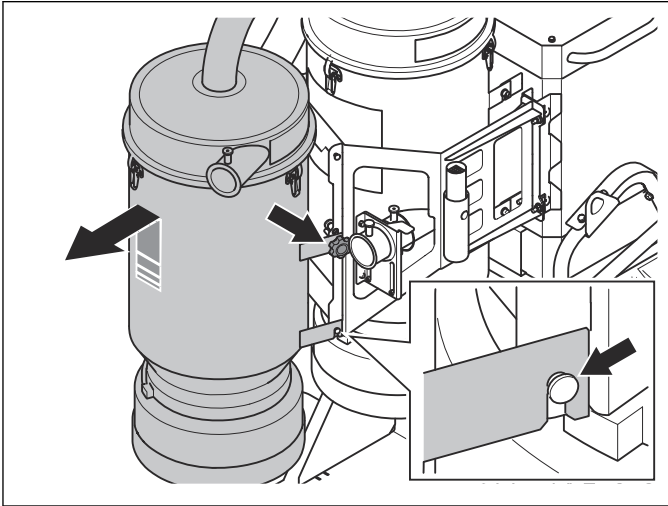

4. Lift the pre-separator tank and remove it. The pre-separator tank is attached with 4 hooks.
5. Install in the opposite sequence.

5.6.2 To remove and install the frame for the pre-separator tank (accessory)

1. Remove the Longopac if it is installed.
2. Remove the pre-separator tank. Refer to *To remove and install the pre-separator tank (accessory) on page 11*.
3. Remove the 8 nuts (A), the 8 washers (B), and the frame (C). There are 4 nuts and 4 washers on the right and left side of the frame.

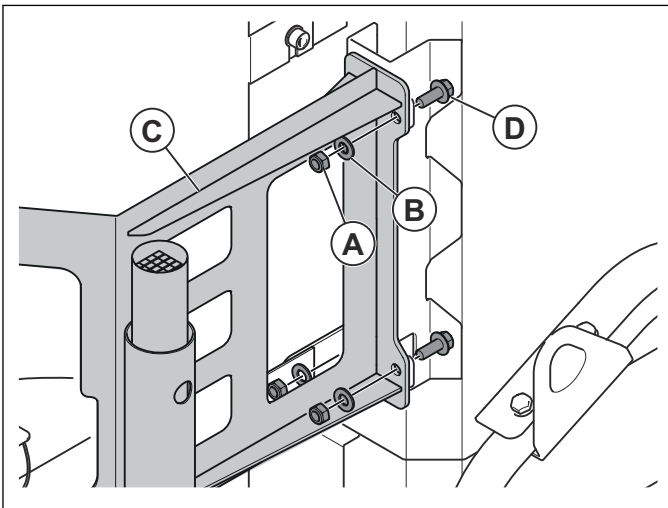

WARNING: The frame comes loose when the nuts and the washers are removed.

4. Remove the 8 screws (D).
5. Install in the opposite sequence.

5.6.3 To remove and install the container

1. If the pre-separator is installed, remove it. Refer to *To remove and install the pre-separator tank (accessory) on page 11*.
2. Remove the Longopac if it is installed.
3. Disconnect the 2 hoses from the top cover.

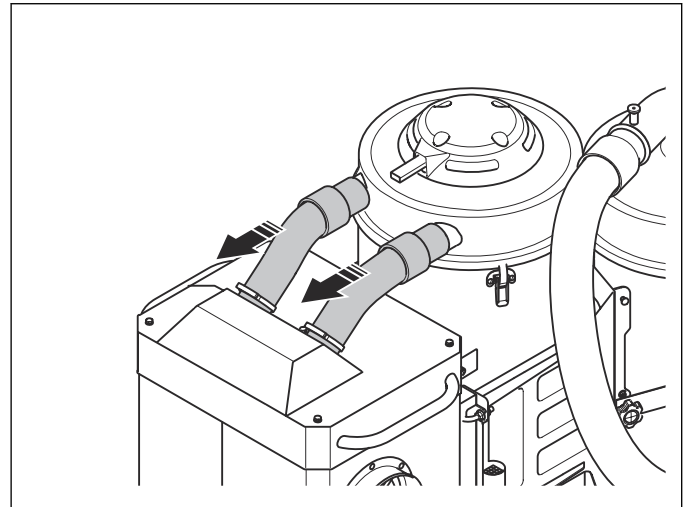

4. Loosen the 4 screws. There are 2 screws on the right and left side of the product.

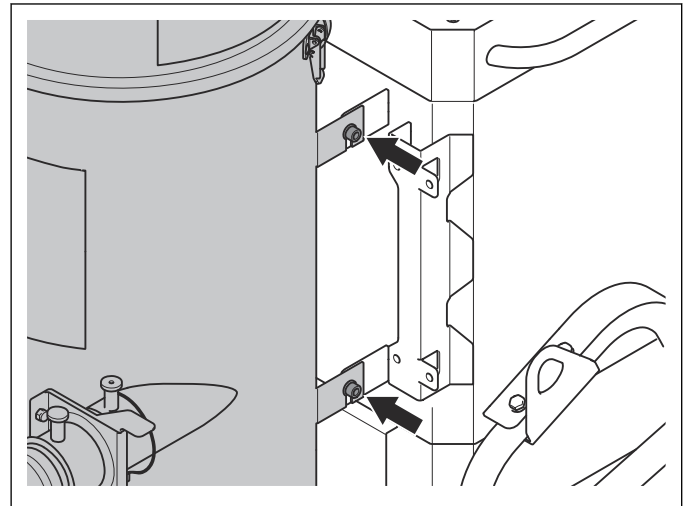

5. Lift the container and remove it. The container is attached with 4 hooks.
6. Install in the opposite sequence.

5.6.4 To clean and examine the container

1. Examine the container for damage.
2. Make sure that the bottom lid opens and closes correctly.
3. Remove dust from the container with a moist cloth.
4. Replace decals that are damaged.

5.7 Fans

5.7.1 To remove and install the motor housing

1. Remove the HEPA filters. Refer to *To replace the HEPA filters on page 10*.
2. Remove the generator. Refer to *To remove and install the generator on page 9*.
3. Carefully remove the 5 screws and the 5 washers from below the motor housing. The motor housing comes loose.

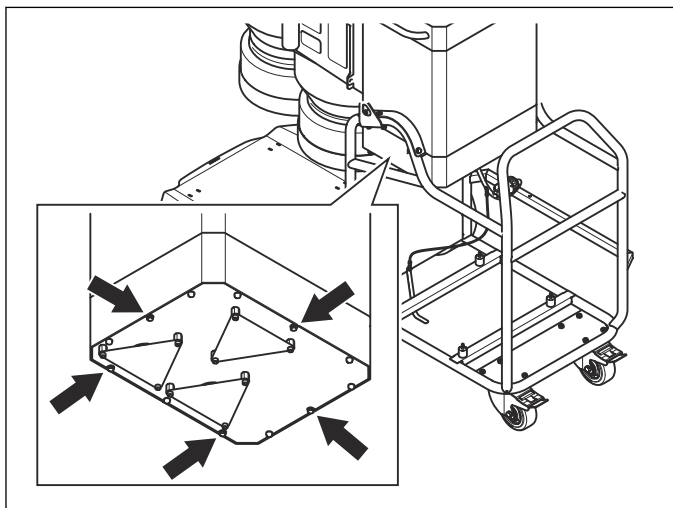

WARNING: The motor housing comes loose when you remove the screws.

4. Remove the motor housing.

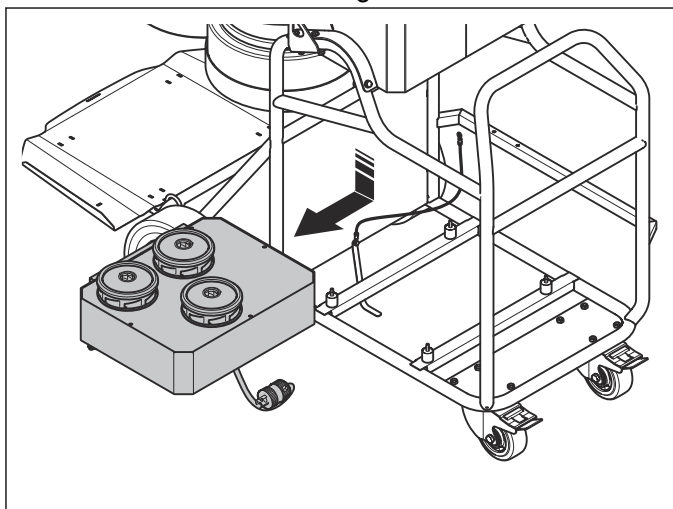

5. Install in the opposite sequence. Apply Loctite 243 threadlocker on all threads.

5.7.2 To replace the fans

1. Remove the HEPA filters. Refer to *To replace the HEPA filters on page 10*.
2. Remove the generator. Refer to *To remove and install the generator on page 9*.
3. Remove the motor housing. Refer to *To remove and install the motor housing on page 13*.

4. Remove the 7 screws, the 7 washers, and the bottom plate from the motor housing.

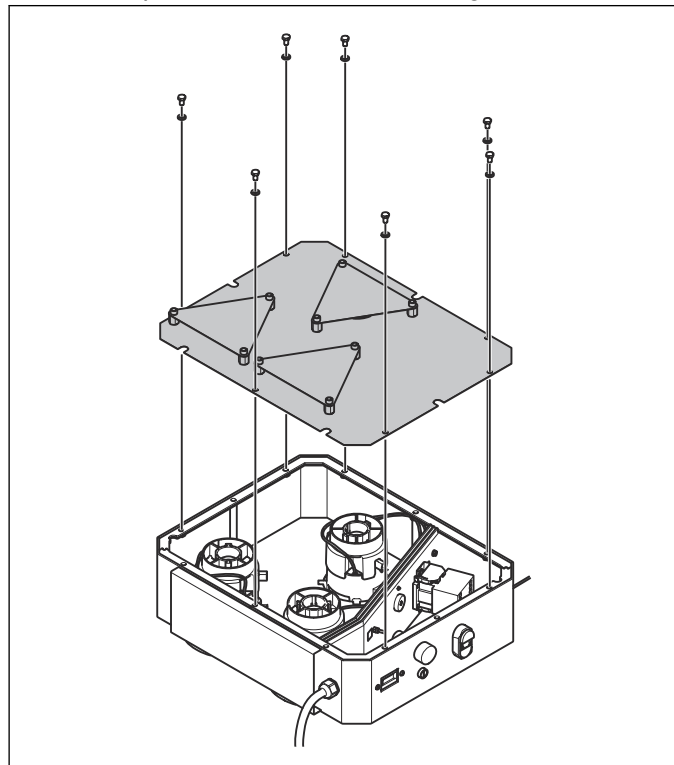

5. Remove the 3 cool air conductors.

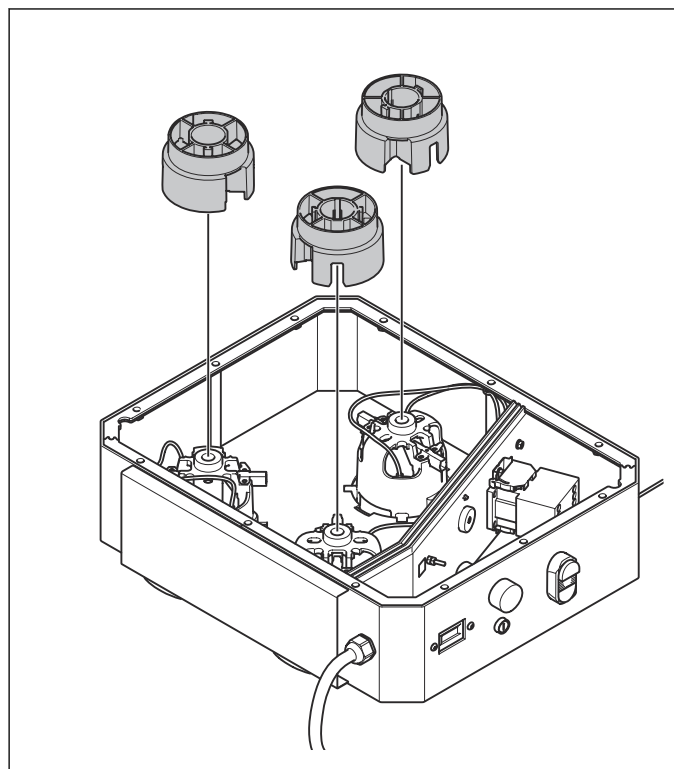

6. Make a note of how the cables are attached in the motor housing.

7. Disconnect the cables from the fans.

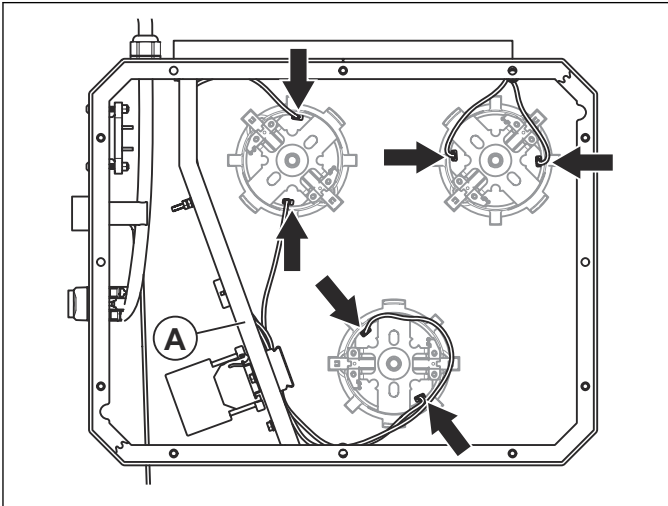

8. Examine the seal (C). Replace the seal if it is worn or damaged.
9. Remove the seals (D) and the fans (E).

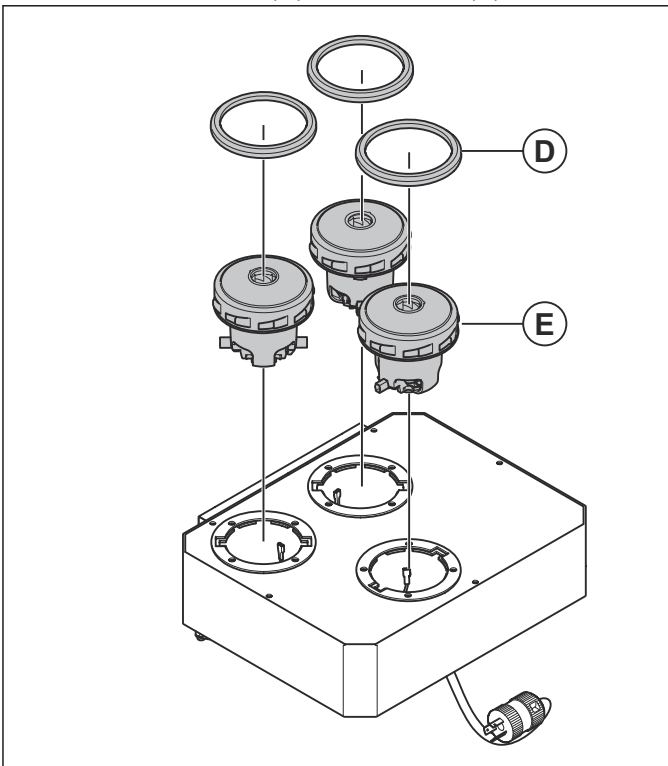

10. Install a new fan in the opposite sequence. Apply Loctite 243 threadlocker on all threads.

5.8 Electrical system

5.8.1 To replace the fuses

1. Remove the fuse holder (A).

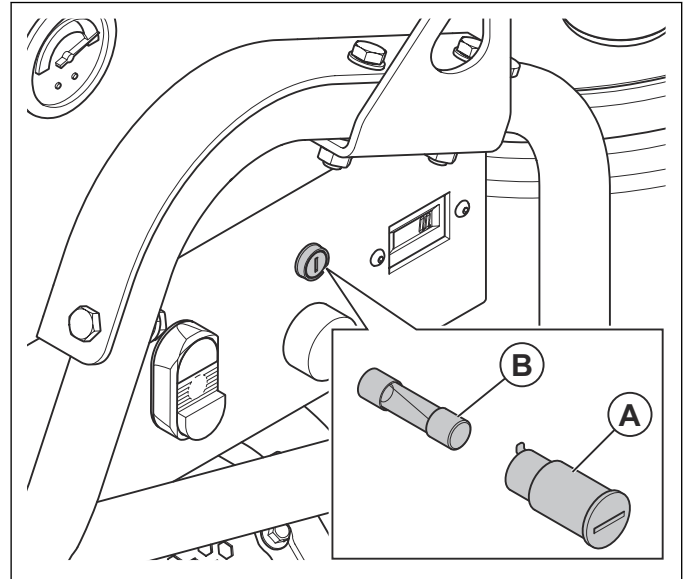

2. Pull the fuse (B) from the fuse holder.
3. Put a new fuse in the fuse holder.
4. Install the fuse holder.

5.8.2 To replace the ON/OFF button

1. Remove the generator. Refer to *To remove and install the generator on page 9*.
2. Remove the 7 screws, the 7 washers, and the bottom plate from the motor housing.

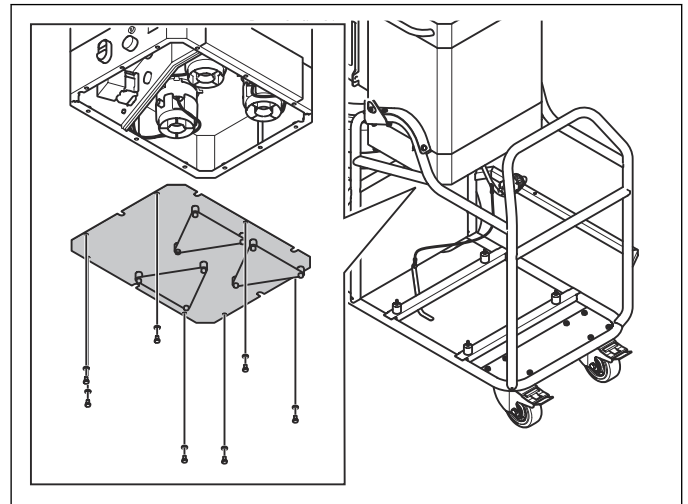

3. Disconnect the connectors from the ON/OFF button.

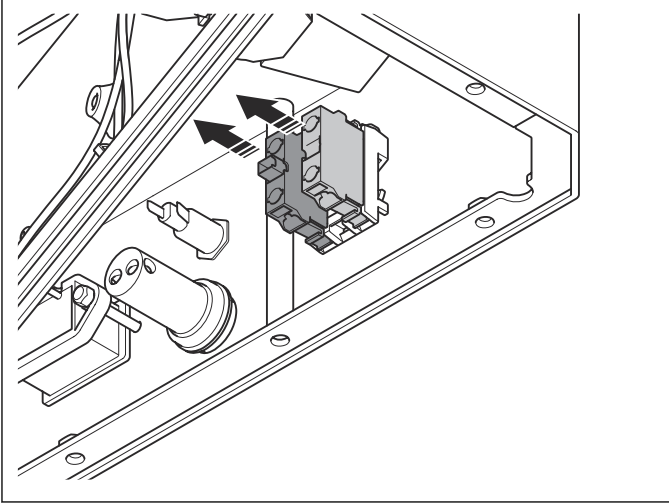

4. Remove the ON/OFF button.

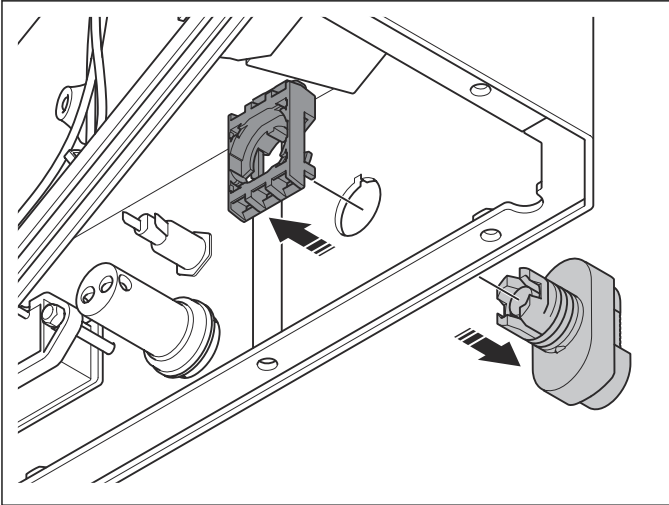

5. Install a new ON/OFF button in the opposite sequence.

5.8.3 To replace the hour meter

1. Remove the generator. Refer to *To remove and install the generator on page 9*.
2. Remove the 7 screws, the 7 washers, and the bottom plate from the motor housing.

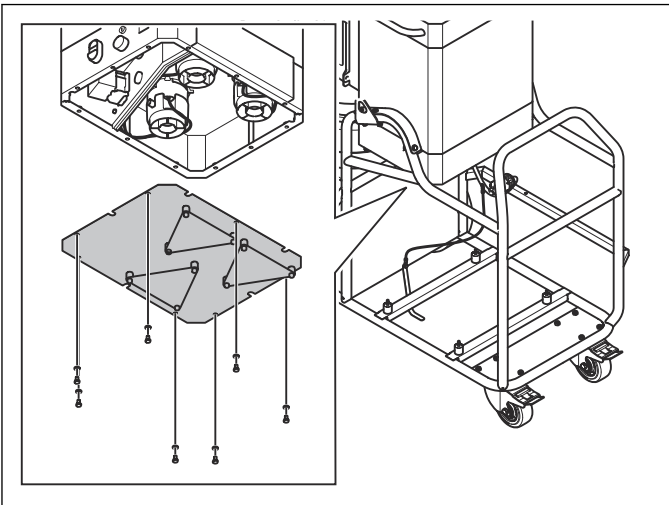

3. Disconnect the connectors from the hour meter.

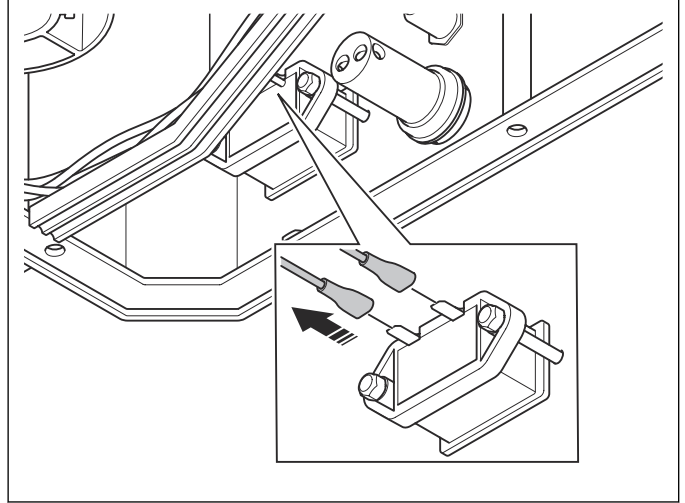

4. Remove the 2 screws, the 2 nuts, and the hour meter.

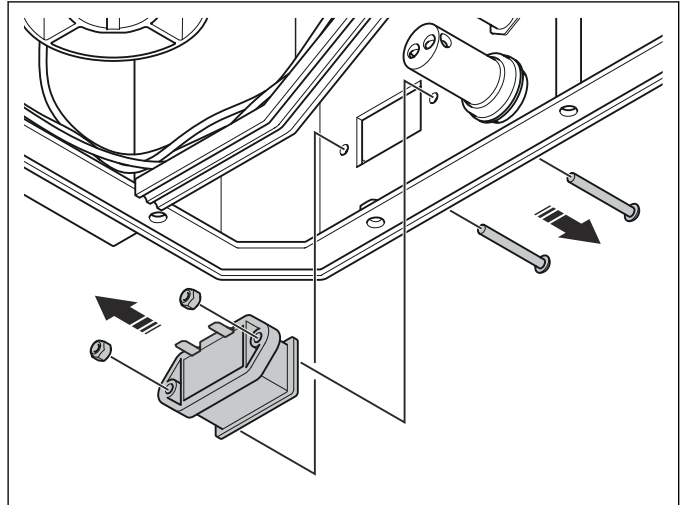

5. Install a new hour meter in the opposite sequence.

6 Transportation

6.1 Transportation of the product

- Make sure that the Longopac bag is empty before a transportation.
- Make sure that the Longopac bag is attached to the product during transportation.
- Make sure that there is no leakage of dust during transportation. The vacuum hose must be attached to the inlet of the pre-separator tank and the inlet plug must be attached to the inlet valve of the primary tank.
- Be very careful when you move the product up and down ramps. The product is heavy and there is a risk of injury if the product falls or moves too quickly. For ramps with a large angle, always use a winch. Do not walk or stay below the product.
- Attach the product safely at the tie-down points during transportation to prevent damage and accidents.
- Lock the caster wheels.
- If possible, do the transportation of the product during good weather conditions.
- If possible, use a closed vehicle during transportation of the product.
- Let the engine become cool before you put the product onto the vehicle. A warm engine and exhaust system can burn you and ignition can occur with some material.
- During transportation, battery must be safely attached and fully disconnected at all times.

7 Troubleshooting

7.1 Troubleshooting

Problem	Cause	Solution
The product does not start	The product is not connected to the generator.	Connect the product to the generator.
	There is no power from the generator.	Refer to the documentation for the generator.
The generator and the fan operates but there is no suction.	The hose is not connected.	Connect the hose.
	The hose is clogged or blocked.	Clean the hose.
	There is no Longopac bag.	Install a Longopac bag.
The generator and the fan operates but the suction is unsatisfactory.	The hose is damaged.	Replace the hose.
	The prefilter is clogged.	Clean the prefilter. If it is necessary, replace the prefilter.
	The HEPA filter is clogged.	Replace the HEPA filter.
	The top cover is loose.	Adjust the top cover.
	There is dirt in the lid.	Clean the lid.
Dust is blown from engine.	The prefilter or/and the HEPA filter are incorrectly installed or damaged.	Adjust or replace the prefilter or/and the HEPA filter.
Unusual noise.	N/A	Do servicing on the product.

8 Diagrams

8.1 Electrical diagram

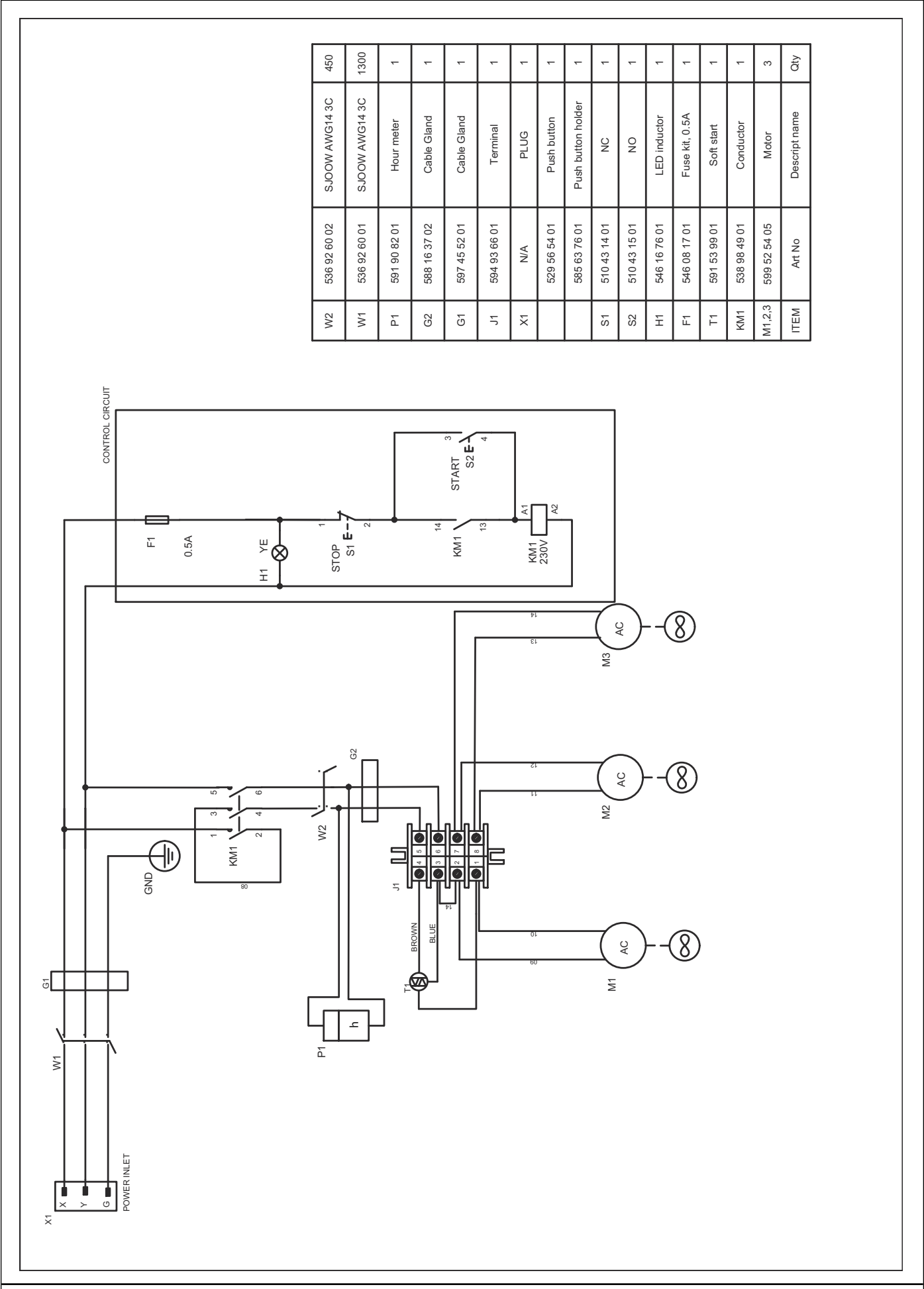

8.2 Electrical diagram

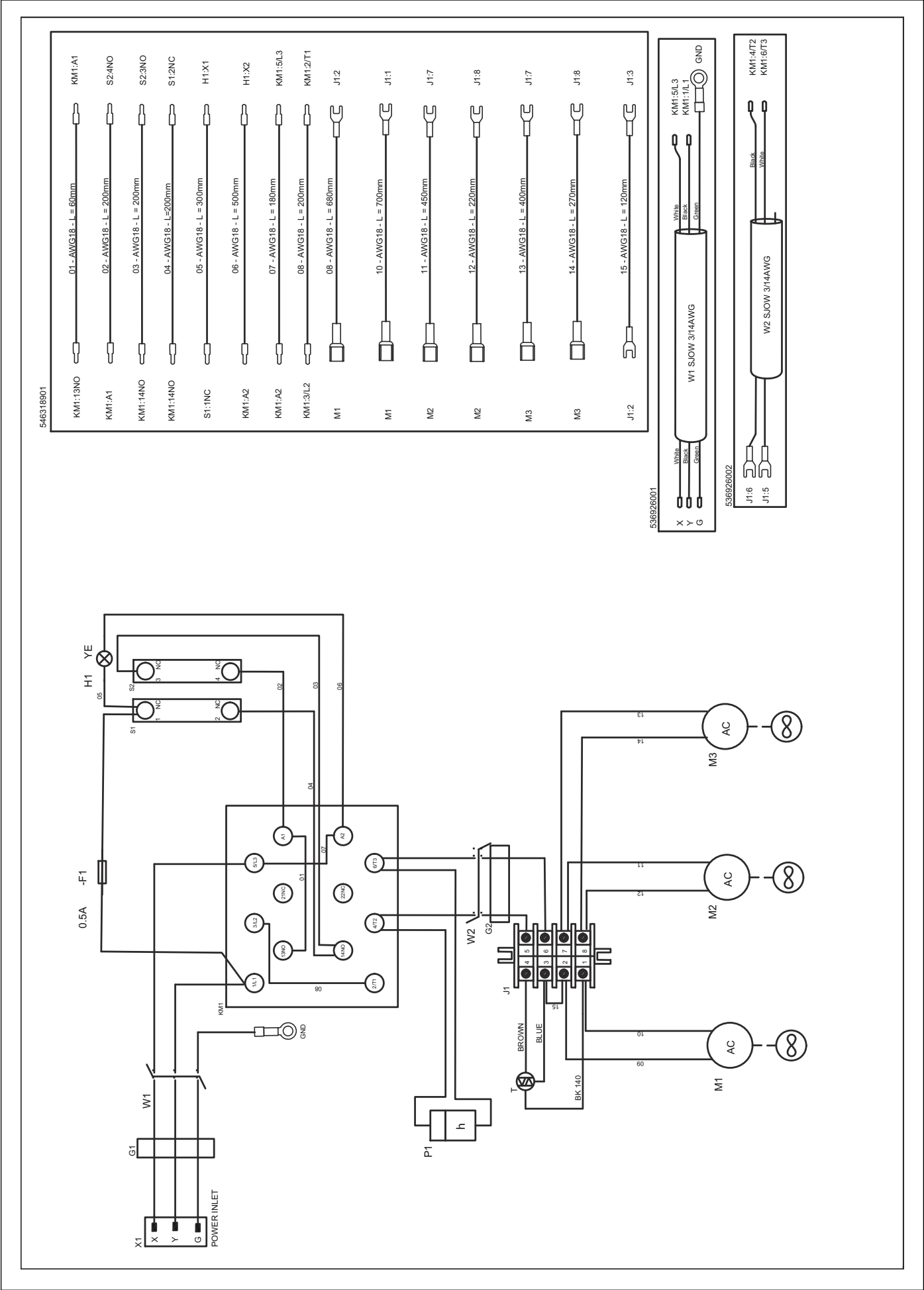

9 Technical data

9.1 Technical data

Data	
Engine brand/type ¹	Honda/
Engine power, HP/kW. ²	10.2/7.6
Starter	Electric
Battery type (recommended)	AGM (Gel)
Battery Voltage, V	12
Battery size, max (LxWxH), in./mm	5.9×3.4×5.7/150×88×145
Battery capacity, min Ah	12
Cold cranking, min Amperes	220
Max airflow, CFM/h/m ³ /h	285/484
Max vacuum, kPa	26
Water Lift, in.	104
Main Hose diameter, in./mm	2.5/63
Main Hose length, ft/m	10/3
Inlet diameter, in./mm	2.5/63
Prefilter EN779-F8, % @ 1µm	99.5%
Prefilter Area, ft ² /m ²	50/4.6
HEPA filter EN1822-H13, % @0.3µm	>99.99
HEPA filter, quantity	2
Total HEPA filter area, ft ² /m ²	27/2.5
Dust Collection system, Type	Longopac
Filter cleaning mechanism	Jet Pulse
Weight uncrated, lbs/kg	523/237
Dimensions (L*W*H), in./mm	63×29×63/1608×733×1609
Fuel amount in tank, max, Gal/L	0.5/1.8
Engine fuel, oil and parts.	Refer to engine manufacturer manual.
Noise emissions ³	
Sound power level L _{WA} measured, dB(A)	103
Sound levels ⁴	
Sound pressure level L _{PA} at the operators ear, dB(A)	92

¹ Refer to the operators manual or web site of the engine manufacturer for more information about the engine.

² As specified by engine manufacturer. The power rating of the engines indicated is the average net power output (at specified rpm) of a typical production engine for the engine model measured to ISO3046, SAE J1940/J1995. Mass production engines may differ from this value. Actual power output for the engine installed in the final product will depend on the operating speed, environmental conditions and other variables.

³ Noise emissions in the environment measured as sound power (LWA) in conformity with IEC/EN 60335-2-69. Uncertainty Kwa 2dB.

⁴ Sound pressure level according to IEC/EN 60335-2-69. Uncertainty KPA 2dB.

Data	
Vibration levels ⁵	
Handle right, m/s ²	1.1
Handle left, m/s ²	1.1

⁵ Vibration level according to IEC/EN 60335-2-69. Reported data for vibration level has a typical statistical dispersion (standard deviation) of 1.5 m/s².



www.husqvarna.com

1143806-26

2024-02-06