

## SB, Sprocket retainer 534529101 (979077) + protection plate 546615101 (E20290), 2023-06

### SYMPTOM/DESCRIPTION

To improve safety, a new sprocket retainer has been developed to cover the drive sprocket and the chain (pos. no. 28 in figure 1). This retainer ensures that no objects can become trapped between the drive sprocket and the chain.

### AFFECTED UNITS

All Blastrac blue-coloured units are mentioned below:  
The new sprocket is already implemented on all new Husqvarna orange-coloured units.

- 1-8DPF40
- 1-8DPS30
- 1-8DPS55

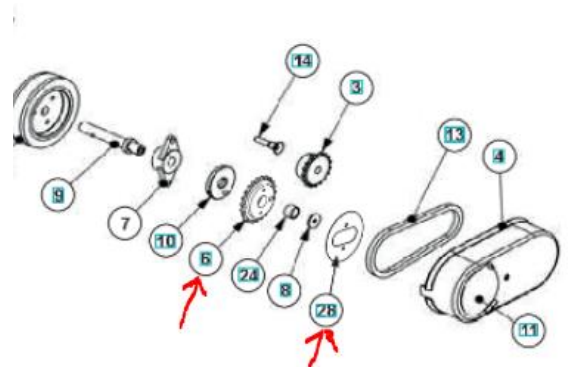

Fig. 1: New Sprocket retainer, pos. 28.

### CORRECTIVE ACTION

The drive sprocket **534529101 (979077)** has got a new revision "B" (2x M6 thread holes added). Adding the new sprocket retainer **546615101 (E20290)** to cover the drive sprocket.

### PROCEDURE

Refer to Appendix A.

### PARTS INFORMATION

What parts to order and how? *Order from EPC:*

1. **Protection plate: 546615101 (E20290).**
2. **Sprocket Rev. "B" 534529101 (979077).**
3. **2x M6x10 hex. socket cap screw.**

Scrap parts in local stock? - Yes, sprocket rev. "A" 534529101 (979077) without 2x M6 thread holes is to be scrapped.

Update products in local stock? - Yes

Recall products from customers and update? - No

Update sold products during next service if part caused a problem or anyway? – *Replace only if fails.*

### WARRANTY INFORMATION

Normal warranty policy applies.

**Revision History**

<b>Rev.</b>	<b>Date</b>	<b>Order id.</b>	<b>Description</b>
<b>A</b>	2023-06	00029916	Created
<b>B</b>	2024-02	00039454	The drive sprocket 534529101 (979077) has got a new revision "B"

## Appendix A

### Step 1:

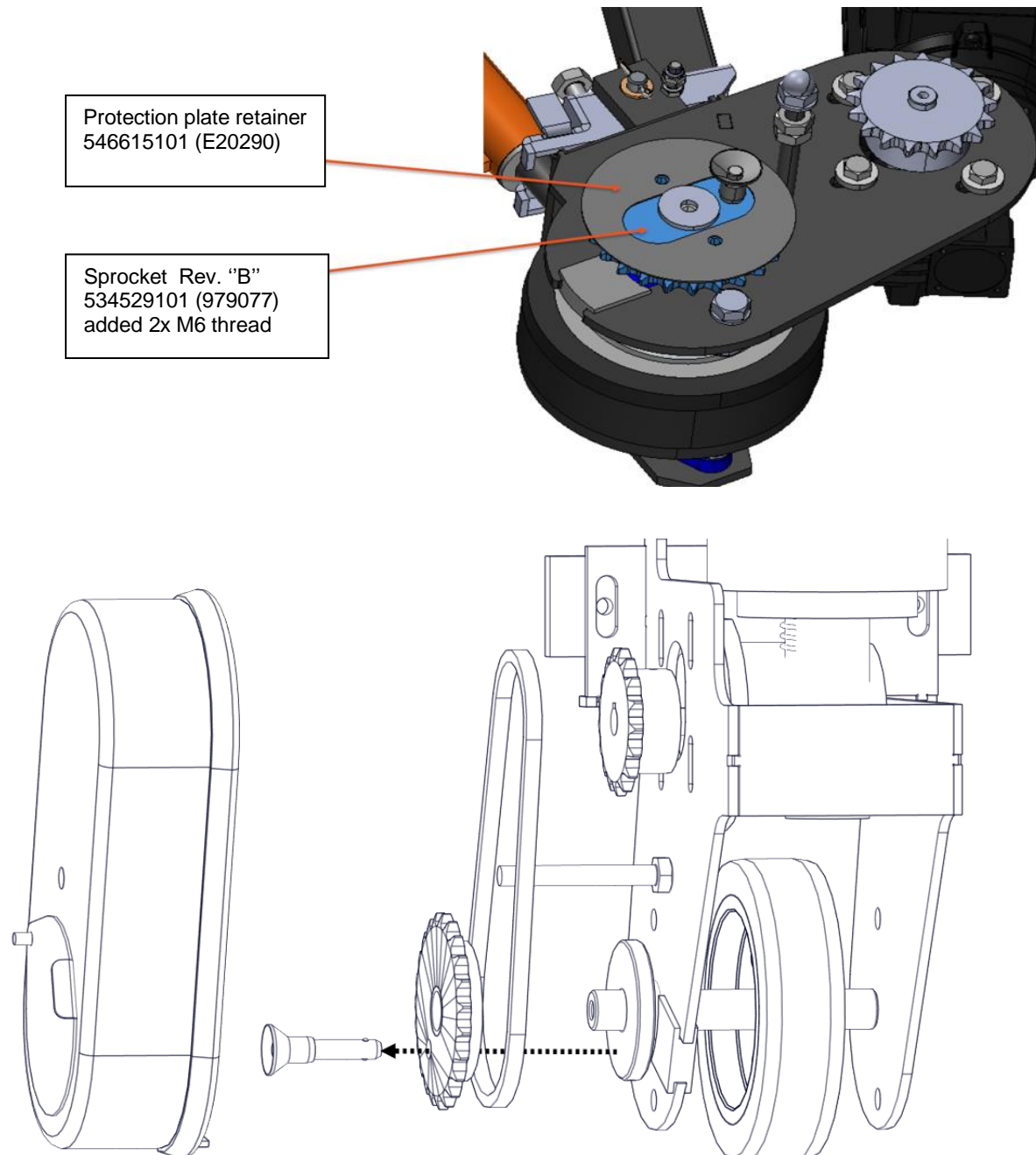

1. Dismount the chain cover.
2. Dismount the chain.
3. Dismount the old drive sprocket.
4. Please note, the old drive sprocket rev. "A" doesn't have 2x M6 thread holes.

#### Step 2:

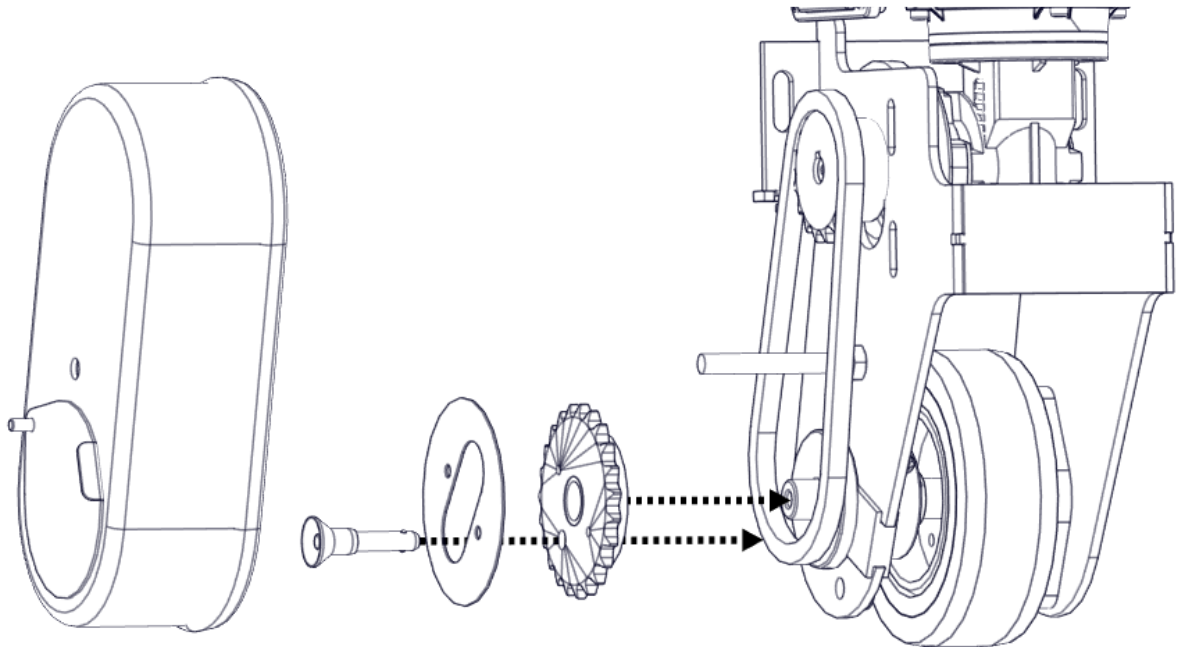

1. Mount the drive sprocket Rev. "B" (534529101) with 1x M8x10 Bolt, big washer and spring washer.
2. Mount the chain.
3. Mount the protection plate (546615101) with 2x M6x10 Bolts and spring washers.
4. Mount the quick-release pin.
5. Mount the chain cover.
6. Please note, the sprocket Rev. "B" has 2x M6 thread holes (shown in the picture above with 2 green arrows).