

SB, Upgraded cutting head, BS75, BS110, 2024-03

SYMPTOM/DESCRIPTION

We have developed a new cutting head for BS75 and BS110 to use slotted blades. The new cutting head allows better tightening of the slotted blades and the 'non' slotted blades are now expired and eliminated for sale. The new cutting head has been implemented on all rebranded products. **Refer to Appendix A** "General explanation & FAQ" for how to recognize the old and new system.

AFFECTED UNITS

All Blue BS75 & BS110 products in all markets.

CORRECTIVE ACTION

Recommended to replace the rebuild spare parts per product version.

PROCEDURE

Refer to Appendix B for BS75 & BS110 rebuild spare parts.

PARTS INFORMATION

What parts to order and how? *Order from EPC:*

1. Refer to Appendix B, check the product model in the table to see which part(s) you actually need to order.
2. Scrap parts in local stock? – *No (old system kit is still active for sales).*
3. Update products in local stock? – *No*
4. Recall products from customers and update? – *No*
5. Update sold products during next service if part caused a problem or anyway? – *No, the new system is optional so please communicate this change to the customer.*

WARRANTY INFORMATION

Normal warranty policy applies.

Revision History

Rev.	Date	Order id.	Description
A	2024-03	00040604	Created

Appendix A

General explanation & FAQ (Frequently Asked Questions):

Why are there new blades and toolholders for the scrapers?

This improvement was already planned for a while, therefore, with the brand change, we decided that it would be the perfect opportunity to switch over to the new slotted blades and new toolholders.

Do the new blades fit inside the old holders?

Yes, the new blades fit inside the old holders. And the old blades fit inside the new holders. Except for the Super-Duty blades (4mm), they only fit inside the new holders.

Why do the new cuttingheads of the BS-75 and BS-110 have 3 bolts instead of 5 bolts?

The new blades have built-in slots, so the 3 bolts clamp the blades even better than the old system. The new slotted-system clamps the blades so well, that there is no more need for 5 bolts. This means that the customers can change blades quicker, thus saving valuable time and money.

Why M10 bolts instead of M12 bolts?

The new holders have M10 bolts because they “stick out” less in the holder, so there is a smaller chance that something gets caught behind the head of the bolt. The M10 bolts have a higher hardness class (C10.9 instead of C8.8) which makes them equally strong as the previously used M12 bolts. The new holders are also standard equipped with Nordlock-washers, which will hold the bolts perfectly in place, even when exposed to severe vibration and dynamic loads.

Why is the cutting edge (bevel) changed on the Self-Scoring blades?

Having the bevel down on the Self-Scoring blades is a huge benefit because it will keep the blades sharper for a longer period during work. It also makes them much easier, quicker and safer to re-sharpen when the blades are dull. Thus, making the blades more cost-effective. Also, the bevel on the outside cuts the material in the same width as the inside of the blade, which makes the material go smoother through the blade, which results in a quicker way of working. This is a win-win situation for our customers!

What are the new “Super-Duty” blades?

The Super-Duty blades are made of 4mm thick, special hardened steel. The Super-Duty blades can be used as normal flat blades, but also as a chisel! The 2-in-1 functionality makes the Super-Duty blades the ultimate choice for professionals. The super-duty blades perform just as well as the conventional chisels (sometimes even better). With the added benefit that the super-duty blades are easier and quicker to re-sharpen. However, of course, the super-duty blades will wear faster than the chisels.

Has the material of the blade changed?

No, the material has not been changed so the hardness, strength and structure of the material is the same as before.

What should I advise my customers to buy?

The new “Husqvarna-line” blades and holders should be pushed towards the customers.

Who can I contact if I have more questions?

If you have any questions or doubts, please contact our specialists at techsupport.cp.husqvarna.se

Old system (expired) has 5 bolts and old blades have no slots.

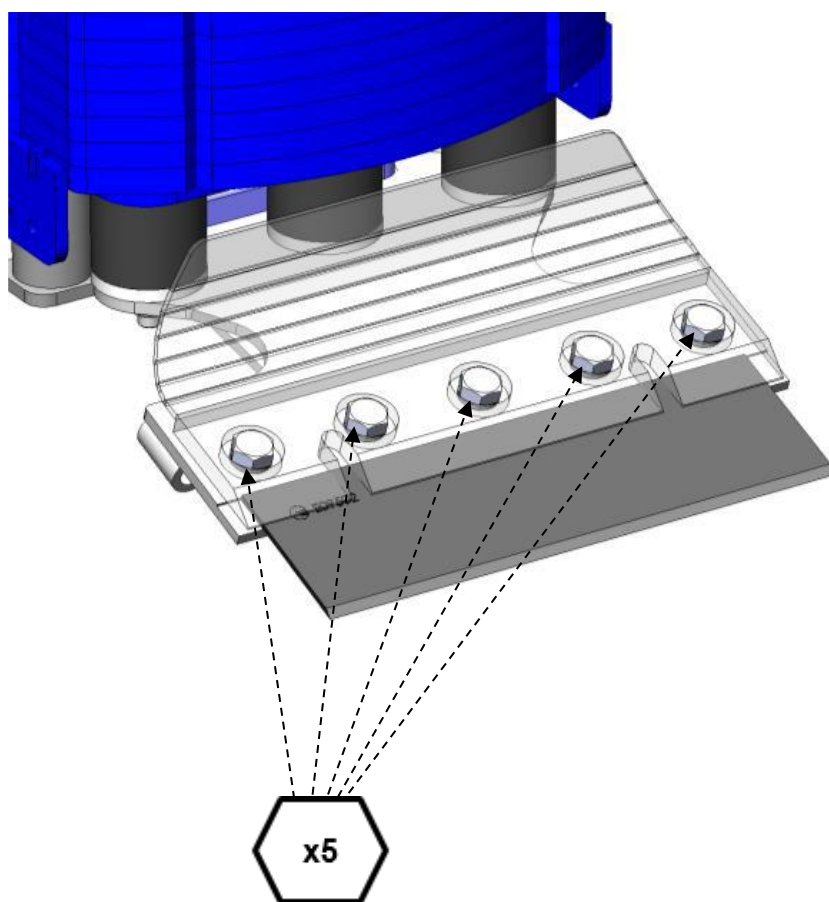
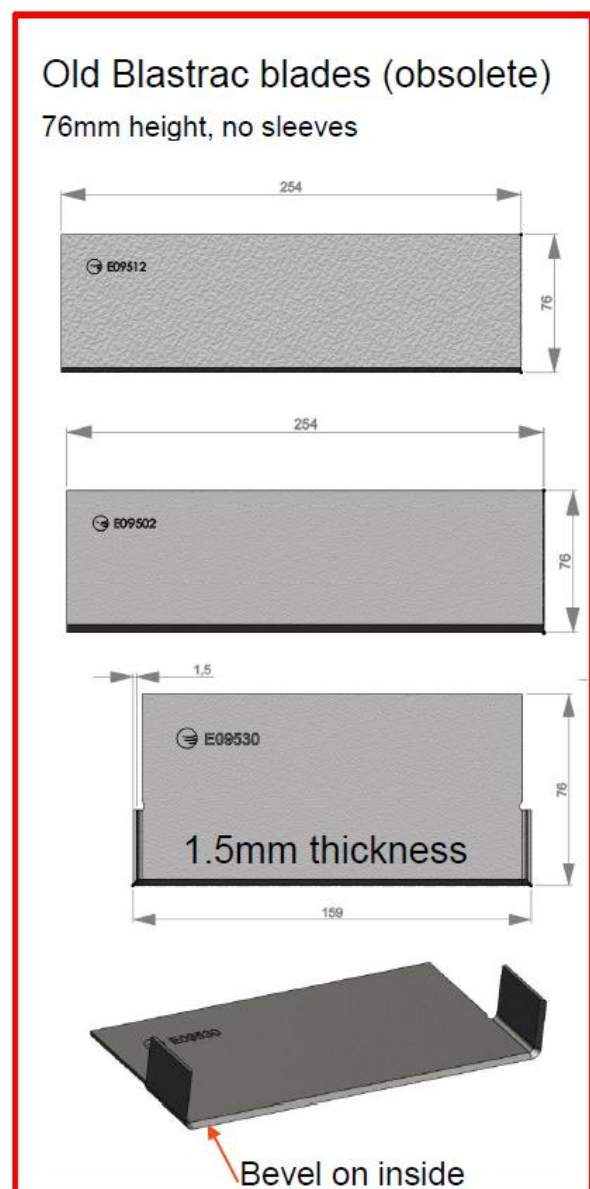

New system "Active" cutting head has 3 bolts to fit the new style blades with slots.

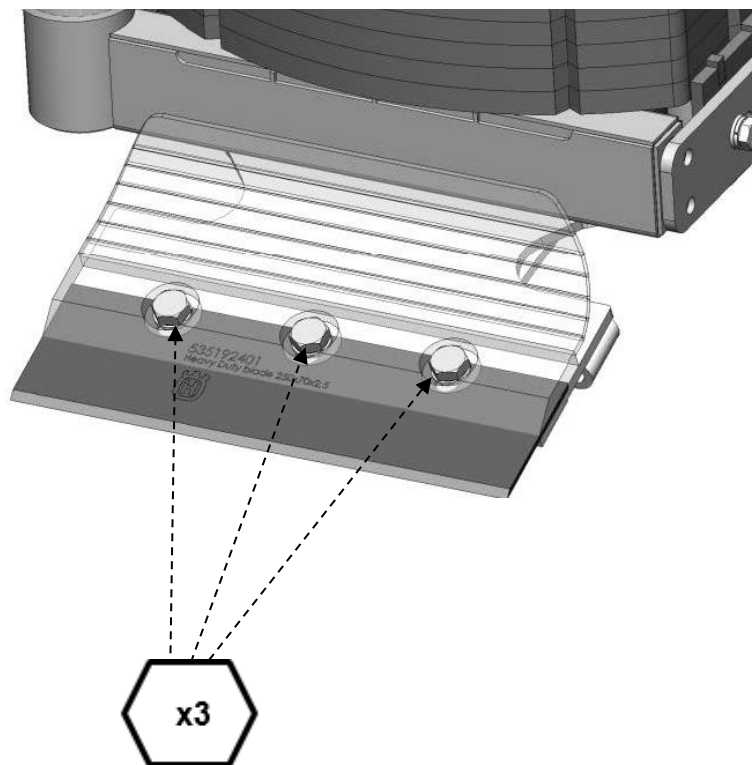
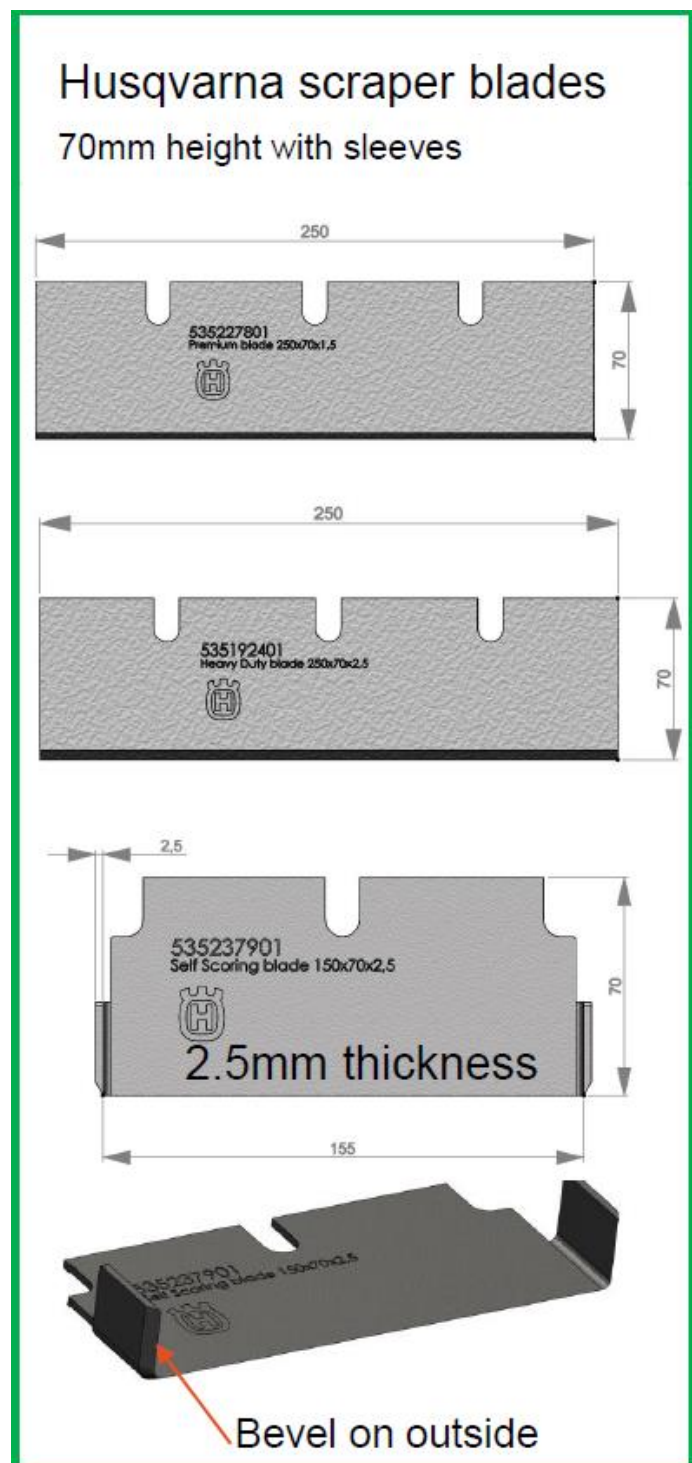

Appendix B

BS75 Rebuild spare parts

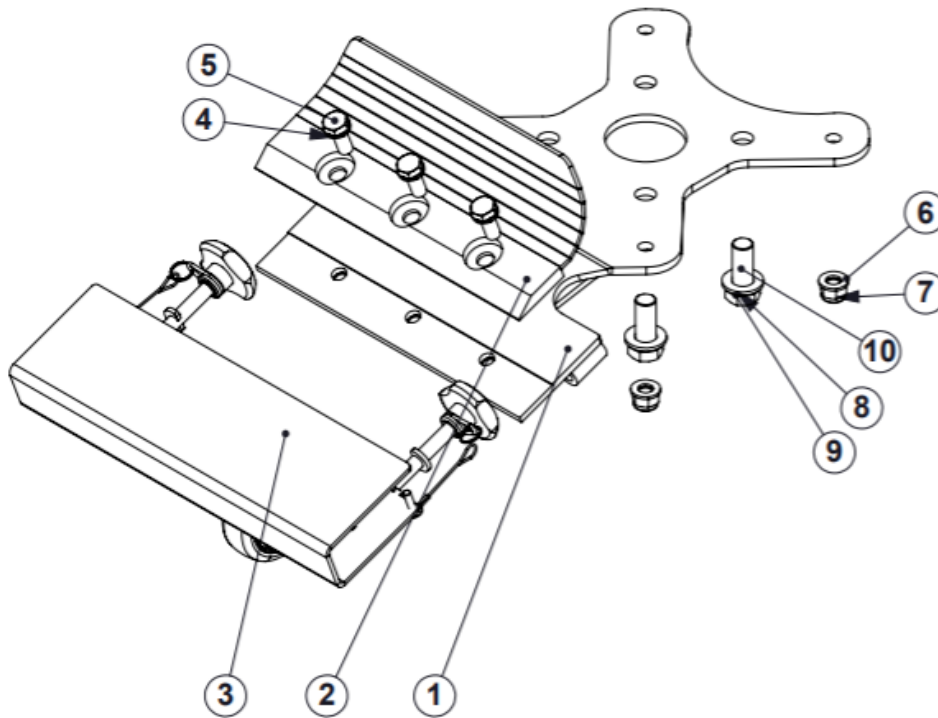

10	4	534685901	ISO 4017 - M14 x 35-C8.8	BE0378
9	4	534684801	Spring washer DIN 128 - A14	
8	4	534684701	Washer ISO 7089 - 14	
7	5	533292901	ISO 7040-M10-N	ISO 7040-M10-N
6	5	533041201	Washer ISO 7089 - 10	
5	3	533041201	ISO 4017 - M10 x 25-C8.8	Screw
4	3	534678201	Spring washer DIN 128 - A10	
3	1	547133301	E19959	Blade protection
2	1	534328702	E19801	Blade cover
1	1	534421602	E19800	Cutting head
ITEM	QTY.	HVA NUMBER	LOCAL ID	DESCRIPTION

BS110 Rebuild spare parts

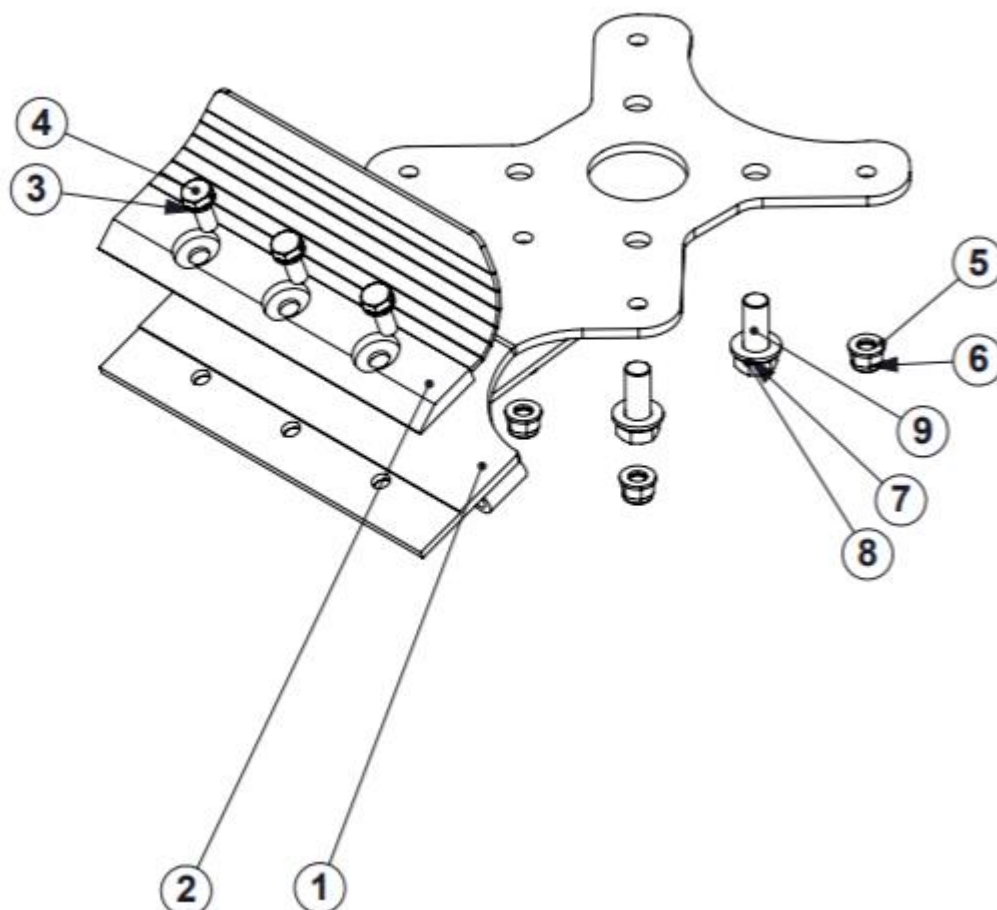

9	4	534685901	ISO 4017 - M14 x 35-C8.8	BE0378
8	4	534684801	Spring washer DIN 128 - A14	
7	4	534684701	Washer ISO 7089 - 14	
6	5	533292901	ISO 7040-M10-N	ISO 7040-M10-N
5	5	533041201	Washer ISO 7089 - 10	
4	3	534678201	ISO 4017 - M10 x 25-C8.8	Screw
3	3	533321101	Spring washer DIN 128 - A10	
2	1	534328702	E19801	Blade cover
1	1	533596902	E19805	Cutting head
ITEM	QTY.	HVA NUMBER	LOCAL ID	DESCRIPTION