

SB, Guide roller 506 35 20-02, K950 Ring, K3600, 2015-09

SYMPTOM/DESCRIPTION

- **Guide roller 506 35 20-02** for the old ring saw models, is superseded by: **Guide roller 506 35 20-05** (pos. 2).
- **Guide roller 506 35 20-02** included **Screw 503 20 13-18** (not shown in the IPL) for the older ring saw models. From now, **Guide roller 506 35 20-05** will be delivered without the screw.
- **Screw 503 20 13-18** has to be ordered separately.

AFFECTED UNITS

The screw is used on the older ring saw models; K950 Ring and K3600.

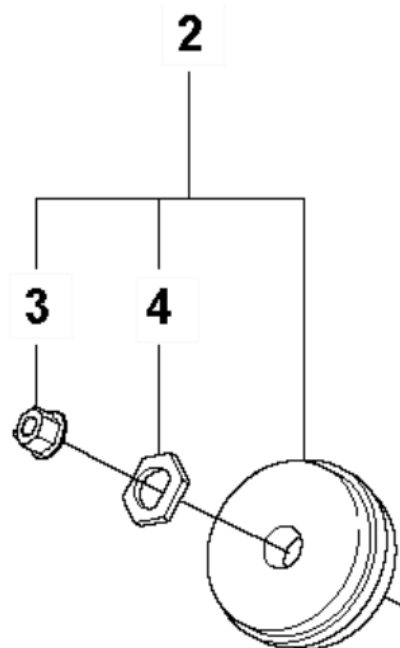

Figure 1: Guide roller 506 35 20-05

PARTS INFORMATION

Old part no.	Part description	New part no.
506 35 20-02	Guide roller	506 35 20-05
-	Screw	503 20 13-18