

SB, Stator, DM220, DM230, 2015-03

SYMPTOM/DESCRIPTION

A new spare part is available for the stator (field coil) of the DM220 and the DM230, for both the 230V and 110V versions. Changes are reflected in the EPC and IPL's.

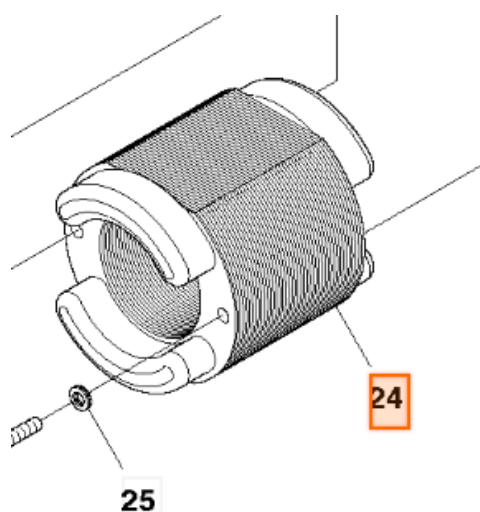

19	576 39 16-01	MOTOR HOUSING	1
20	575 34 79-01	LABEL	1
21	575 34 74-01	LABEL	1
22	575 34 77-01	LABEL	1
23	575 34 73-01	LABEL	1
24	587 23 12-01	STATOR 120V	1
24	587 23 12-02	STATOR 230V	1
25	503 23 04-02	WASHER	2

Figure 1 Example of part numbers as seen on the DM220 EPC "Motor" page.

AFFECTED UNITS

Implementation of parts in production:

Product name	Serial nr
DM220 110V	20151000001
DM220 230V	20151100001
DM230 110V	20151100006
DM230 230V	20150300081

PARTS INFORMATION

Voltage	New part nr	Old part nr
110V	587 23 12-01	579 06 28-01
230V	587 23 12-02	579 06 28-02