



Service bulletin

2008-09-01

515 98 07-01

 740 43 12-00
  740 42 03-00 (x2)
  510 44 09-01

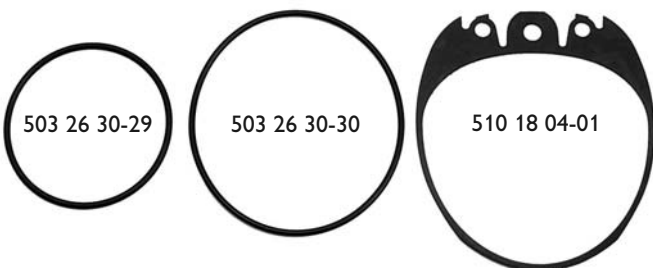

Reinforced seals on DM 230

The seals between the motor/cover and cover/gearbox have been supplemented with gaskets 510 18 04-01 and 510 44 09-01.

Machines which are taken apart for oil changes or due to water/oil leaks must on reassembly be fitted with new O-rings and gaskets which are found in the adjoining kit 515 98 07-01.

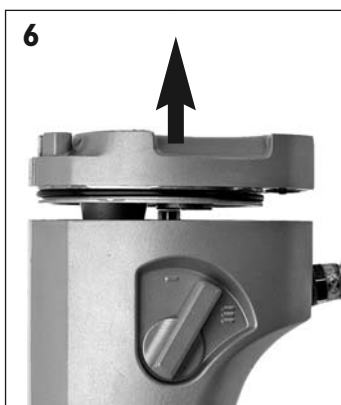
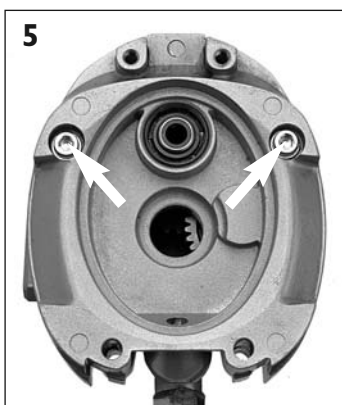
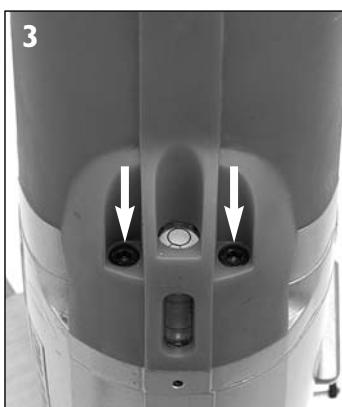

Separation

Electric motor/gearbox

1. Remove both the screws connecting the handle and both the screws keeping the handle in place on the gearbox.
2. Separate the handle into two pieces and remove the handle halves from the gearbox. Leave one handle half hanging in the earth cables.

3. Remove the screws holding the electric motor on the gearbox.
4. Lift the electric motor off the gearbox.

Cover/gearbox

5. Remove both the screws.
6. Take the cover off the gearbox.

Service bulletin

2008-09-01

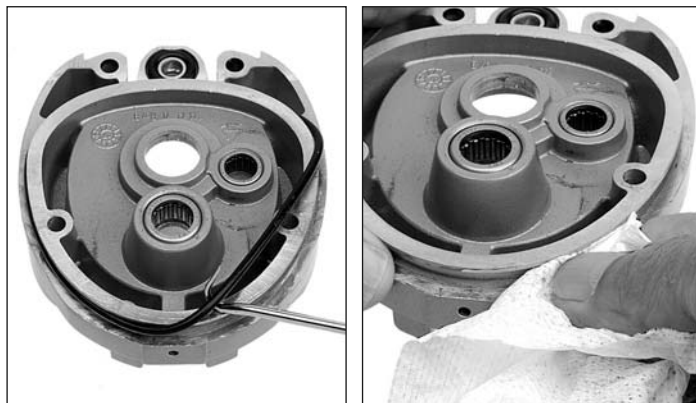

Seals – cover/gearbox

Remove the old O-ring and clean the slot it was taken from.

Also clean the surfaces where gasket 510 18 04-01 will be positioned.

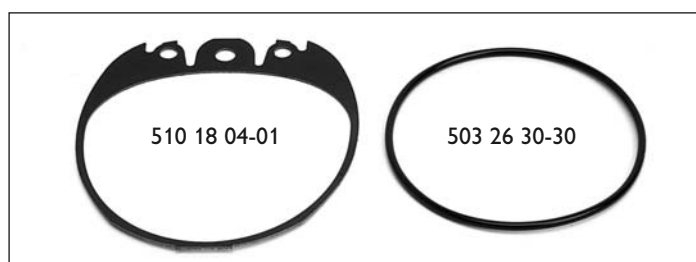

To seal the cover to the gearbox, use gasket 510 18 04-01 and O-ring 503 26 30-30.

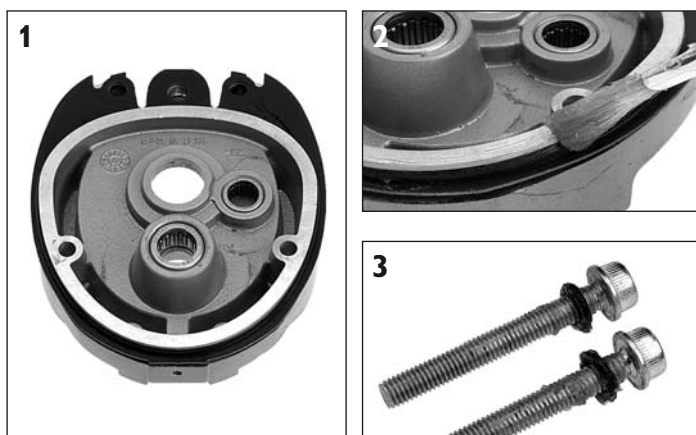

1. Position the gasket in place in the cover first.

2. Fit the O-ring and apply grease to it.

3. Replace the O-rings (740 42 03-00) for the screws. Apply grease to the O-rings.

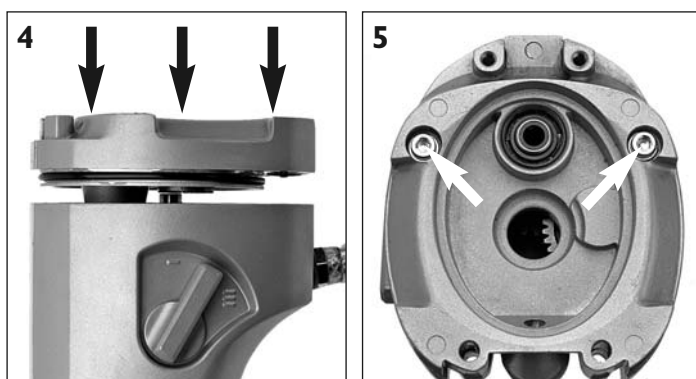

4. Press the cover right down in parallel to the gearbox.

5. Fit the screws and tighten them crosswise.

Service bulletin

2008-09-01

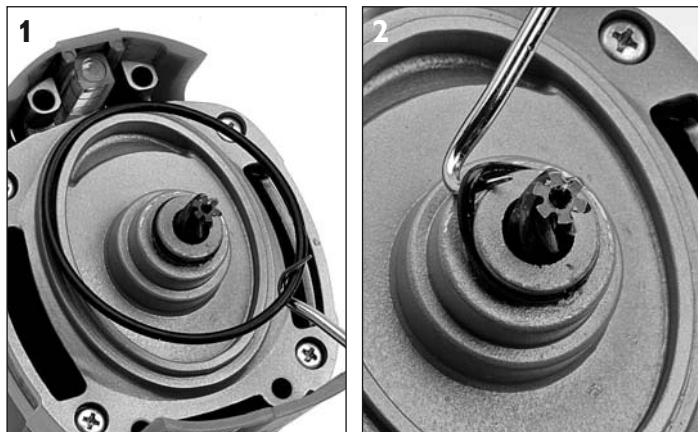

Seals – motor/cover

1. Remove the outer O-ring.
2. Remove the inner O-ring.



Carefully clean around the O-rings and the surface touching gasket 510 44 09-01 in the cover.

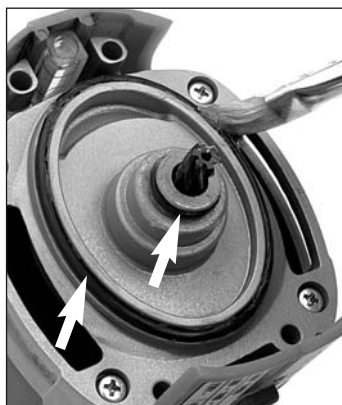

Fit O-rings 503 26 30-29 and 740 43 12-00.

Apply grease to the O-rings.

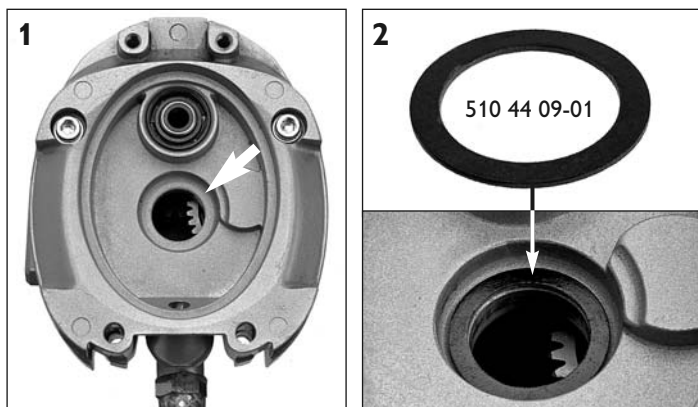

1. Check that the gasket surface is undamaged and clean it.
2. Centre gasket 510 44 09-01 carefully in place in the cover.

Reassembly

Reassemble the motor on the gearbox according to the initial description but in reverse order.

Important

So as not to damage the gaskets it is important that the motor meets the gearbox with precision when assembled. Press the motor to the gearbox evenly by tightening the screws cross-wise.